

TABLE OF CONTENTS

STANDARD HARDWARE

MACHINE SCREWS - Flat, Oval, Pan, Round, Truss.....	3
SHEET METAL SCREWS.....	5
THREAD CUTTING SCREWS.....	5
CAP SCREWS - Button, Flat, Socket, Torx.....	5
SET SCREWS.....	6
BOLTS - Hex, Socket Head Shoulder, Thru.....	6
NUTS - Hex, Hex Jam, with Ny-Lock insert, with Star Lock Washer, Slotted, Wing.....	8
WASHERS - Flat, Star Lock, Special, Split Lock.....	9
PINS - Clevis, Cotter, Roll.....	10
RIVETS.....	11
KEYS.....	11
TAMPER PROOF.....	11
MISCELLANEOUS	12

METRIC HARDWARE

BOLTS / SCREWS.....	12
DOWELS / KEYS / PINS / RIVETS / NUTS.....	14
WASHERS.....	15

While the competition utilizes low carbon steel hardware on their equipment, **99%** of NSS® hardware is stainless steel.

HOW TO MEASURE HARDWARE:



TERMINOLOGY CROSS REFERENCE

<u>Old Terminology</u>	<u>New Terminology</u>
Allen Head	Socket Head
Cap Screw	Hex Bolt
ESNA	Hex Nut with Ny-Lock Insert
External Tooth Lock Washer	External Star Lock Washer
Fin Hex Jam Nut	Hex Jam Nut
Hex Cap Screw	Hex Bolt
Hex Head	Hex Bolt
Hex Nut w/ Nylon Insert	Hex Nut with Ny-Lock Insert
Hex Tap Bolt	Hex Bolt
Internal Tooth Lock Washer	Internal Star Lock Washer
Jam Nut	Hex Jam Nut
K-Nut	Hex Nut with Star Lock Washer
Keys Nut	Hex Nut with Star Lock Washer
Pan Head Self Tapping M/S	Pan Head Phillips Thread Cutting Screw
Socket Set Knurl Point	Set Screw Knurl Point

COMMONLY SEEN ABBREVIATIONS IN NSS ILLUSTRATED PARTS LISTS

<u>Abbreviation</u>	<u>Full Description</u>
C/S	Cap Screw
L/N	Lock Nut
L/W	Lock Washer
M/S	Machine Screw
PHIL	Phillips
PT	Point
RD	Round
SMS	Sheet Metal Screw
TCS	Thread Cutting Screw
HD	Head

RULER

MACHINE SCREWS

FLAT HEAD MACHINE SCREWS

Part No.	Size	Description	Package Quantity
9120300	8-32 X 3/8	FLAT HEAD PHILLIPS MACHINE SCREW	10
9120250	8-32 X 5/8	FLAT HEAD PHILLIPS MACHINE SCREW	10
9120305	8-32 X 3/4	FLAT HEAD PHILLIPS MACHINE SCREW	10
9120390	10-24 X 3/8	FLAT HEAD PHILLIPS MACHINE SCREW	10
9120540	10-24 X 1/2	FLAT HEAD PHILLIPS MACHINE SCREW	10
9120550	10-24 X 5/8	FLAT HEAD PHILLIPS MACHINE SCREW	10
9120400	10-24 X 3/4	FLAT HEAD PHILLIPS MACHINE SCREW	10
9120670	10-32 X 5/8	FLAT HEAD PHILLIPS MACHINE SCREW	10
9120772	10-32 X 3/4	FLAT HEAD PHILLIPS MACHINE SCREW	10
9121037	1/4-20 X 5/8	FLAT HEAD PHILLIPS MACHINE SCREW	10
9121035	1/4-20 X 7/8	FLAT HEAD PHILLIPS MACHINE SCREW	5
9121030	1/4-20 X 1 1/4	FLAT HEAD PHILLIPS MACHINE SCREW	5
9121470	5/16-18 X 1	FLAT HEAD PHILLIPS MACHINE SCREW	2

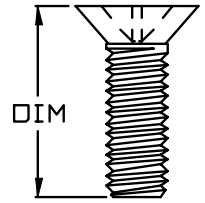

OVAL HEAD MACHINE SCREWS

Part No.	Size	Description	Package Quantity
9120585	10-24 X 1/2	OVAL HEAD PHILLIPS MACHINE SCREW	10
9122060	3/8-16 X 1 1/4	OVAL HEAD PHILLIPS MACHINE SCREW	1

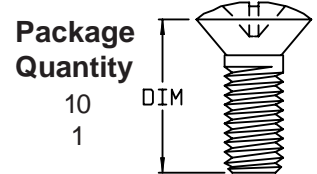

PAN HEAD MACHINE SCREWS

Part No.	Size	Description	Package Quantity
9120012	4-40 X 3/8	PAN HEAD PHILLIPS MACHINE SCREW	5
9120014	4-40 X 7/8	PAN HEAD PHILLIPS MACHINE SCREW	2
7490201	6-32 X 1/4	PAN HEAD PHILLIPS MACHINE SCREW	1
9120060	6-32 X 5/16	PAN HEAD SLOT MACHINE SCREW - BRASS	10
9120090	6-32 X 7/8	PAN HEAD PHILLIPS MACHINE SCREW	10
9120110	6-32 X 1 1/8	PAN HEAD PHILLIPS MACHINE SCREW	10
9120120	6-32 X 1 3/4	PAN HEAD PHILLIPS MACHINE SCREW	10
9120223	8-32 X 1/4	PAN HEAD PHILLIPS MACHINE SCREW	5
9120230	8-32 X 1/2	PAN HEAD PHILLIPS MACHINE SCREW	10
9120290	8-32 X 5/8	PAN HEAD PHILLIPS MACHINE SCREW	10
9120635	10-24 X 7/8	PAN HEAD PHILLIPS MACHINE SCREW	10
9120715	10-32 X 1/2	PAN HEAD PHILLIPS MACHINE SCREW	5
9120771	10-32 X 5/8	PAN HEAD PHILLIPS MACHINE SCREW	5
9120775	10-32 X 1 1/8	PAN HEAD PHILLIPS MACHINE SCREW	5
9120777	10-32 X 1 1/4	PAN HEAD PHILLIPS MACHINE SCREW	5
6191091	10-32 X 1 3/4	PAN HEAD PHILLIPS MACHINE SCREW	1
9121040	1/4-20 X 5/8	PAN HEAD PHILLIPS MACHINE SCREW	5
7490561	1/4-20 X 3/4	PAN HEAD SLOT MACHINE SCREW	1

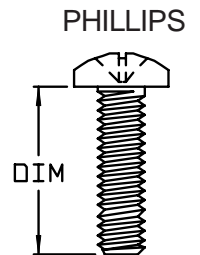
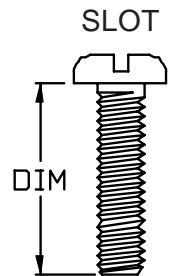

MACHINE SCREWS - cont.

ROUND HEAD MACHINE SCREWS

Part No.	Size	Description	Package Quantity
9120050	6-32 X 5/16	ROUND HEAD PHILLIPS MACHINE SCREW	10
9120070	6-32 X 3/8	ROUND HEAD PHILLIPS MACHINE SCREW	10
9120080	6-32 X 3/4	ROUND HEAD PHILLIPS MACHINE SCREW	10
9120100	6-32 X 1	ROUND HEAD PHILLIPS MACHINE SCREW	10
9120220	8-32 X 3/8	ROUND HEAD PHILLIPS MACHINE SCREW	10
9120240	8-32 X 1/2	ROUND HEAD PHILLIPS MACHINE SCREW	10
9120245	8-32 X 5/8	ROUND HEAD PHILLIPS MACHINE SCREW	10
9120260	8-32 X 3/4	ROUND HEAD PHILLIPS MACHINE SCREW	10
9120270	8-32 X 7/8	ROUND HEAD PHILLIPS MACHINE SCREW	10
9120280	8-32 X 1	ROUND HEAD PHILLIPS MACHINE SCREW	10
9120380	10-24 X 3/8	ROUND HEAD PHILLIPS MACHINE SCREW	10
9120385	10-24 X 3/8	ROUND HEAD PHILLIPS MACHINE SCREW - WITH SEALANT	2
9120440	10-24 X 7/16	ROUND HEAD PHILLIPS MACHINE SCREW	10
9120410	10-24 X 1/2	ROUND HEAD PHILLIPS MACHINE SCREW	10
9120420	10-24 X 5/8	ROUND HEAD PHILLIPS MACHINE SCREW	10
9120580	10-24 X 5/8	ROUND HEAD SLOT MACHINE SCREW - BRASS	10
9120430	10-24 X 3/4	ROUND HEAD PHILLIPS MACHINE SCREW	10
9120450	10-24 X 1	ROUND HEAD PHILLIPS MACHINE SCREW	10
9120460	10-24 X 1 1/4	ROUND HEAD PHILLIPS MACHINE SCREW	5
9120470	10-24 X 1 1/2	ROUND HEAD PHILLIPS MACHINE SCREW	5
9120480	10-24 X 1 3/4	ROUND HEAD PHILLIPS MACHINE SCREW	5
9120490	10-24 X 2	ROUND HEAD PHILLIPS MACHINE SCREW	5
9120493	10-24 X 3	ROUND HEAD SLOT MACHINE SCREW	2
9120720	10-32 X 3/8	ROUND HEAD PHILLIPS MACHINE SCREW	10
9120730	10-32 X 1/2	ROUND HEAD PHILLIPS MACHINE SCREW	10
9120770	10-32 X 5/8	ROUND HEAD PHILLIPS MACHINE SCREW	10
9120780	10-32 X 1 1/4	ROUND HEAD SLOT MACHINE SCREW	5
6190171	10-32 X 1 1/2	ROUND HEAD PHILLIPS MACHINE SCREW	1
9121045	1/4-20 X 1/2	ROUND HEAD PHILLIPS MACHINE SCREW	10
9121049	1/4-20 X 1	ROUND HEAD SLOT MACHINE SCREW - PLASTIC	5
9121070	1/4-20 X 1 3/4	ROUND HEAD PHILLIPS MACHINE SCREW	5
9121150	1/4-20 X 2 1/4	ROUND HEAD PHILLIPS MACHINE SCREW	2
9121480	5/16-18 X 1	ROUND HEAD PHILLIPS MACHINE SCREW	2
9122040	3/8-16 X 1	ROUND HEAD PHILLIPS MACHINE SCREW	1
9122045	3/8-16 X 2 1/4	ROUND HEAD SLOT FULL THREADED MACHINE SCREW	1

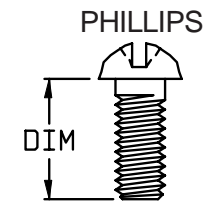
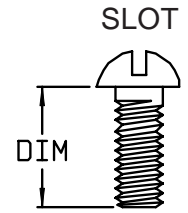

TRUSS HEAD MACHINE SCREWS

Part No.	Size	Description	Package Quantity
9120210	8-32 X 1/4	TRUSS HEAD PHILLIPS MACHINE SCREW	10
9120500	10-24 X 3/8	TRUSS HEAD PHILLIPS MACHINE SCREW	10
9120510	10-24 X 1/2	TRUSS HEAD PHILLIPS MACHINE SCREW	10
9120520	10-24 X 5/8	TRUSS HEAD PHILLIPS MACHINE SCREW	10
9120530	10-24 X 7/8	TRUSS HEAD PHILLIPS MACHINE SCREW	10
9120535	10-24 X 1 1/2	TRUSS HEAD PHILLIPS MACHINE SCREW	5
9120740	10-32 X 3/8	TRUSS HEAD PHILLIPS MACHINE SCREW	10
9120750	10-32 X 1/2	TRUSS HEAD PHILLIPS MACHINE SCREW	10
9120990	1/4-20 X 3/8	TRUSS HEAD PHILLIPS MACHINE SCREW	5
9121090	1/4-20 X 1/2	TRUSS HEAD PHILLIPS MACHINE SCREW	5
9121000	1/4-20 X 5/8	TRUSS HEAD PHILLIPS MACHINE SCREW	5
9121010	1/4-20 X 3/4	TRUSS HEAD PHILLIPS MACHINE SCREW	5
9121020	1/4-20 X 1	TRUSS HEAD PHILLIPS MACHINE SCREW	5
9121130	1/4-20 X 1 1/2	TRUSS HEAD PHILLIPS MACHINE SCREW	5

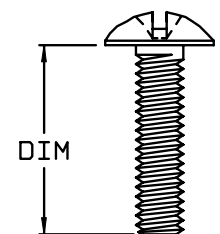

SET SCREWS - BOLTS

SET SCREWS

Part No.	Size	Description	Package Quantity
9120170	8-32 X 3/16	SET SCREW - KNURL POINT - STEEL	5
9120225	8-32 X 1/4	SET SCREW - KNURL POINT - ALLOY	10
9120637	10-24 X 1/4	SET SCREW - CUP POINT	5
9120640	10-32 X 1/4	SET SCREW - CUP POINT	10
9120650	10-32 X 3/4	SET SCREW - CUP POINT	5
9120655	10-32 X 1 3/4	SET SCREW - CUP POINT	1
9120840	1/4-20 X 3/16	SET SCREW - KNURL POINT	5
9120850	1/4-20 X 5/16	SET SCREW - KNURL POINT	2
9120860	1/4-20 X 3/8	SET SCREW - CUP POINT	5
9120870	1/4-20 X 1/2	SET SCREW - CUP POINT	5
9121120	1/4-20 X 5/8	SET SCREW - KNURL POINT	5
9121110	1/4-20 X 3/4	SET SCREW - CUP POINT - ALLOY	5
9121365	1/4-28 X 1/4	SET SCREW - KNURL POINT	1
9121380	5/16-18 X 3/8	SET SCREW - KNURL POINT	2
6190831	5/16-18 X 1/2	SET SCREW - FULLDOG	1
9121383	5/16-18 X 1 1/4	SET SCREW - CUP POINT	1
9121385	5/16-18 X 2 1/4	SET SCREW - CUP POINT	1
9122050	3/8-16 X 1 1/2	SET SCREW - CUP POINT	1
9122353	3/8-16 X 3	SET SCREW - CUP POINT	1

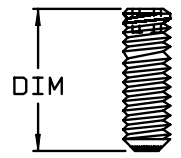

KNURL POINT

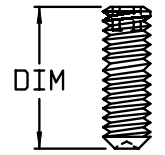

CUP POINT

HEX BOLTS

Part No.	Size	Description	Package Quantity
9121160	1/4-20 X 3/8	HEX BOLT	5
9121170	1/4-20 X 1/2	HEX BOLT	10
9121210	1/4-20 X 5/8	HEX BOLT	10
9121250	1/4-20 X 3/4	HEX BOLT WITH NYLON PATCH	10
9121270	1/4-20 X 1	HEX BOLT	10
9121060	1/4-20 X 1 1/4	HEX BOLT	5
9121280	1/4-20 X 1 1/2	HEX BOLT	5
9121145	1/4-20 X 2	HEX BOLT - STEEL - ZINC PLATE	5
9121287	1/4-20 X 2 1/2	HEX BOLT - STEEL	2
9121350	1/4-20 X 3	HEX BOLT	3
9121080	1/4-20 X 3 1/2	HEX BOLT	2
9121360	1/4-20 X 4	HEX BOLT	2
9121560	5/16-18 X 1/2	HEX BOLT	5
9121600	5/16-18 X 5/8	HEX BOLT	5
9121640	5/16-18 X 3/4	HEX BOLT	5
6593631	5/16-18 X 3/4	HEX BOLT	1
9121680	5/16-18 X 1	HEX BOLT	5
9121720	5/16-18 X 1 1/4	HEX FULL THREADED BOLT	2
9121780	5/16-18 X 1 1/2	HEX BOLT	2
9121760	5/16-18 X 1 3/4	HEX BOLT	2
9121800	5/16-18 X 2	HEX BOLT	2
9122130	5/16-18 X 2 1/4	HEX BOLT	2
9121840	5/16-18 X 2 1/4	HEX FULL THREADED BOLT	1
9121845	5/16-18 X 2 1/2	HEX BOLT	2
9121370	5/16-18 X 3 1/4	HEX BOLT	2
9121490	5/16-24 X 7/8	HEX BOLT	2
9122220	3/8-16 X 3/4	HEX BOLT	5
9122260	3/8-16 X 1	HEX BOLT	2
9122300	3/8-16 X 1 1/4	HEX BOLT	2
9122075	3/8-16 X 1 1/2	HEX BOLT	2

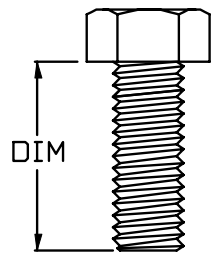
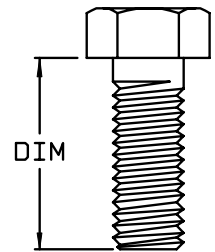

FULL THREADED

HEX BOLTS - cont.

Part No.	Size	Description	Package Quantity
9122340	3/8-16 X 2	HEX BOLT	2
9122343	3/8-16 X 2	HEX FULL THREADED BOLT	1
6190791	3/8-16 X 2 1/4	HEX BOLT	1
9122080	3/8-16 X 2 1/2	HEX BOLT	1
9122345	3/8-16 X 2 1/2	HEX FULL THREADED BOLT	1
9122350	3/8-16 X 3	HEX BOLT	1
9122090	3/8-16 X 3 1/2	HEX BOLT	1
9122370	3/8-16 X 3 3/4	HEX BOLT	1
9122371	3/8-24 X 2 1/8	HEX BOLT	1
6190801	7/16-20 X 1 1/4	HEX BOLT	1
9122380	7/16-20 X 1 1/4	HEX BOLT - ZINC	2
9122500	1/2-13 X 7/8	HEX BOLT	2
9122530	1/2-13 X 1	HEX BOLT	1
9122540	1/2-13 X 1 1/4	HEX BOLT	1
9122550	1/2-13 X 1 1/2	HEX BOLT	1
9122570	1/2-13 X 1 3/4	HEX BOLT	1
9122580	1/2-13 X 2	HEX BOLT	1
9122650	1/2-13 X 2 1/4	HEX BOLT	1
9122657	1/2-13 X 3	HEX LOCKING BOLT	1
9122660	1/2-13 X 3	HEX BOLT WITH NYLON PATCH	1
9122665	1/2-13 X 3 1/2	HEX BOLT	1
9122700	1/2-20 X 1	HEX BOLT	2
9122710	1/2-20 X 1 3/4	HEX BOLT	1
9122715	1/2-20 X 5 1/2	HEX BOLT	1

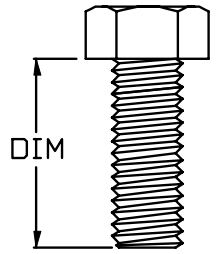
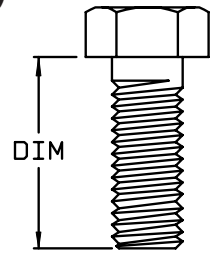

FULL
THREADED

SOCKET HEAD SHOULDER BOLTS

Part No.	Size	Description	Thread Size	Package Quantity
9121289	1/4 DIAMETER X 3/16 LONG	SOCKET HEAD SHOULDER BOLT	10-24	1
9121190	1/4 DIAMETER X 3/8 LONG	SOCKET HEAD SHOULDER BOLT	10-24	1
9121047	1/4 DIAMETER X 1 1/2 LONG	SOCKET HEAD SHOULDER BOLT	10-24	1
9121505	5/16 DIAMETER X 1/8 LONG	SOCKET HEAD SHOULDER BOLT	1/4-20	1
9121550	5/16 DIAMETER X 3/8 LONG	SOCKET HEAD SHOULDER BOLT	1/4-20	1
9121500	5/16 DIAMETER X 1/2 LONG	SOCKET HEAD SHOULDER BOLT	1/4-20	1
9122020	3/8 DIAMETER X 3/8 LONG	SOCKET HEAD SHOULDER BOLT	5/16-18	1
9122025	3/8 DIAMETER X 1/2 LONG	SOCKET HEAD SHOULDER BOLT	5/16-18	1
9122115	3/8 DIAMETER X 3/4 LONG	SOCKET HEAD SHOULDER BOLT	5/16-18	1

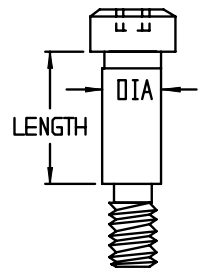

THRU BOLTS

Part No.	Size	Description	Package Quantity
0690671	10-24 X 4	HEX WASHER HEAD THRU BOLT - MACHINED	1
5492801	1/4-20 X 7	HEX WASHER HEAD THRU BOLT	1
3391201	1/4-20 X 7 5/8	HEX HEAD THRU BOLT - MACHINED	1
6491951	1/4-20 X 7 3/4	HEX HEAD THRU BOLT	1
2797601	1/4-20 X 8	HEX HEAD THRU BOLT - MACHINED	1
6493621	1/4-20 X 9	HEX HEAD THRU BOLT	1
6492281	1/4-20 X 9 1/2	HEX HEAD THRU BOLT	1
5093021	1/4-28 X 6 1/2	HEX HEAD THRU BOLT - MACHINED	1

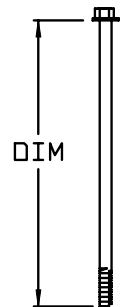

NUTS

HEX NUTS

Part No.	Size	Description	Package Quantity
7490131	8-32	HEX NUT - BRASS	1
9120700	10-32	HEX NUT	10
9120920	1/4-20	HEX NUT	10
9121420	5/16-18	HEX NUT	10
9121530	5/16-24	HEX NUT	5
9122000	3/8-16	HEX NUT	10
9122010	3/8-24	HEX NUT	5

HEX JAM NUTS

Part No.	Size	Description	Package Quantity
9120922	1/4-20	HEX JAM NUT	10
9121540	5/16-18	HEX JAM NUT	10
9121990	3/8-16	HEX JAM NUT	10
9122680	1/2-13	HEX JAM NUT	5
9122670	1/2-20	HEX JAM NUT	5

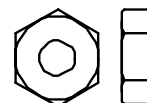

HEX NUTS WITH NY-LOCK INSERT

Part No.	Size	Description	Package Quantity
9120010	4-40	HEX NUT WITH NY-LOCK INSERT	5
9120350	10-24	HEX NUT WITH NY-LOCK INSERT	10
9120660	10-32	HEX NUT WITH NY-LOCK INSERT	10
9120900	1/4-20	HEX NUT WITH NY-LOCK INSERT	10
9120890	1/4-20	HEX NUT WITH NY-LOCK INSERT - THIN	5
7490581	1/4-28	HEX NUT WITH NY-LOCK INSERT	1
9121450	5/16-18	HEX NUT WITH NY-LOCK INSERT	5
9121430	5/16-18	HEX NUT WITH NY-LOCK INSERT - THIN	5
9122140	3/8-16	HEX NUT WITH NY-LOCK INSERT	5
9122507	1/2-13	HEX NUT WITH NY-LOCK INSERT	1
9122495	1/2-13	HEX NUT WITH NY-LOCK INSERT - THIN	1
9122690	1/2-20	HEX NUT WITH NY-LOCK INSERT - THIN	1

HEX NUTS WITH STAR LOCK WASHER

Part No.	Size	Description	Package Quantity
9120015	4-40	HEX NUT WITH STAR LOCK WASHER	2
9120020	6-32	HEX NUT WITH STAR LOCK WASHER	10
9120190	8-32	HEX NUT WITH STAR LOCK WASHER	10
9120360	10-24	HEX NUT WITH STAR LOCK WASHER	10
9120690	10-32	HEX NUT WITH STAR LOCK WASHER	10
9120910	1/4-20	HEX NUT WITH STAR LOCK WASHER	10

HEX SLOTTED NUT (CASTLE)

Part No.	Size	Description	Package Quantity
9122675	1/2-13	HEX SLOTTED NUT	1
9123100	3/4-16	HEX SLOTTED NUT - STEEL - ZINC PLATE	2

WING NUTS

Part No.	Size	Description	Package Quantity
9120680	10-32	WING NUT	2
9121180	1/4-20	WING NUT - PLATED	4
9121440	5/16-18	WING NUT	2
9121445	5/16-18	WING NUT WITH NY-LOCK INSERT	2
9122330	3/8-16	WING NUT - TYPE A	1
9122335	3/8-16	WING NUT WITH NY-LOCK INSERT	1

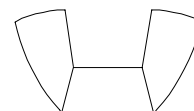

WASHERS

FLAT WASHERS

Part No.	Size	Description	Package Quantity
9120016	#4	FLAT WASHER - REGULAR	1
6190821	#8	SAE FLAT WASHER	1
9120027	5/32 I.D. X 3/8 O.D. X 5/64 THICK	SAE FLAT WASHER (#6)	5
9120185	5/32 I.D. X 1/2 O.D.	WASHER - STEEL - ZINC PLATE	5
9120370	7/32 I.D. X 1/2 O.D. X .032/.065 THICK	FLAT WASHER (#10)	10
9120933	.250 I.D. X .875 O.D. X .075 THICK	FLAT WASHER	6
9120960	1/4 I.D. X 1 O.D.	FLAT WASHER FOR RIVETS	8
9120930	9/32 I.D. X 5/8 O.D. X .051/.080 THICK	FLAT WASHER (1/4)	10
5094111	.281 I.D. X 1.62 O.D. X .131	THICK FLAT WASHER	1
9120940	5/16 I.D. X 3/4 O.D. X .051/.080 THICK	WROUGHT WASHER (1/4)	10
9121390	11/32 I.D. X 11/16 O.D. X .051/.080 THICK	FLAT WASHER (5/16)	10
9121400	3/8 I.D. X 7/8 O.D. X .064/.104 THICK	WROUGHT WASHER (5/16)	10
6190151	5/16	FLAT WASHER	1
6190161	5/16	SAE FLAT WASHER	1
9122180	13/32 I.D. X 13/16 O.D. X .051/.080 THICK	WROUGHT WASHER (3/8)	10
9121985	13/32 I.D. X 1 O.D. X .12 THICK	FLAT WASHER (11 GAGE)	1
9122405	7/16 I.D. X 7/8 O.D. X .028 THICK	FLAT WASHER	1
9121980	7/16 I.D. X 1 O.D. X .075/.080 THICK	FLAT WASHER (3/8)	2
5390811	1/2 I.D. X 1 O.D. X .07 THICK	FLAT WASHER - NYLATRON	1
9122400	1/2 I.D. X 1 3/32 O.D. X .074/.121 THICK	FLAT WASHER (7/16)	10
6190811	7/16	SAE FLAT WASHER	1
9122465	.516 I.D. X .813 O.D. X .027/.030 THICK	FLAT WASHER	2
9122467	.531 I.D. X 1.25 O.D. X .031 THICK	FLAT WASHER	2
9122468	.562 I.D. X 1.25 O.D. X .072 THICK	FLAT WASHER	1
9122450	17/32 I.D. X 1 1/16 O.D. X .074/.121 THICK	FLAT WASHER (1/2)	5
9122470	9/16 I.D. X 1 3/8 O.D. X .086/.132 THICK	WROUGHT WASHER (1/2)	2
4991081	3/4 I.D. X 1 1/4 O.D. X .031 THICK	FLAT WASHER - STEEL	1
9123105	3/4 I.D. X 1 1/4 O.D. X .071/.082 THICK	FLAT WASHER (11 GAGE)	1
4991091	3/4 I.D. X 1 1/2 O.D. X .031 THICK	FLAT WASHER - PLASTIC	1
5091656	7/8 I.D. X 1 3/8 O.D. X .112 THICK	FLAT WASHER	1
9123210	.891 I.D. X 1.5 O.D. X .125 THICK	FLAT WASHER	1
6590521	1 I.D. X 1.5 O.D. X .13 THICK	FLAT WASHER - STEEL - 10 GAGE	1

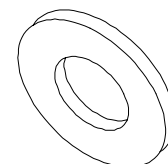

STAR LOCK WASHERS

Part No.	Size	Description	Package Quantity
6190781	1/16	EXTERNAL STAR LOCK WASHER	1
9120130	6	EXTERNAL STAR LOCK WASHER	10
9120330	10	EXTERNAL STAR LOCK WASHER	10
9120340	10	EXTERNAL STAR LOCK WASHER - COUNTER SUNK	5
9120970	1/4	EXTERNAL STAR LOCK WASHER	10
9121410	5/16	EXTERNAL STAR LOCK WASHER	10
9121960	3/8	EXTERNAL STAR LOCK WASHER	10
9121967	7/16	EXTERNAL STAR LOCK WASHER	5
9120040	6	INTERNAL STAR LOCK WASHER	10
9120180	8	INTERNAL STAR LOCK WASHER	10
9120495	10	INTERNAL STAR LOCK WASHER	10
9120945	1/4	INTERNAL STAR LOCK WASHER	2
9121965	3/8	INTERNAL STAR LOCK WASHER	5
0691851	1/2	INTERNAL STAR LOCK WASHER	1
9122800	5/8	INTERNAL STAR LOCK WASHER	5
9122900	3/4	INTERNAL STAR LOCK WASHER	5

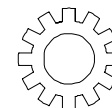

EXTERNAL



INTERNAL

WASHERS - cont. - PINS

SPECIAL WASHERS

Part No.	Size	Description	Package Quantity
9120207	3/16 I.D. X 1/2 O.D.	EYELET - BRASS	2
9120950	1/4 X 1 1/4	FENDER WASHER	5
1392581	.37 I.D. X .612 O.D. X .013 THICK	1 WAVE SPRING WASHER (5/16)	1
9122120	3/8 I.D. X 5/8 O.D. X .031 THICK	1 WAVE SPRING WASHER (3/8)	5
9122110	3/8 X 1 1/2	FENDER WASHER	10
0690831	7/16 I.D. X 13/16 O.D.	FINGERED SPRING WASHER	1
9122705	1/2 I.D. X 3/4 O.D. X .01 THICK	1 WAVE SPRING WASHER (1/2)	2
3290621	5/8 I.D. X 7/8 O.D. X .01 THICK	1 WAVE SPRING WASHER (5/8)	1
9123110	13/16 I.D. X 1 1/8 O.D. X .13 THICK	1 WAVE SPRING WASHER (3/4)	1
3490731	1 1/16 I.D. X 1 1/4 O. D.	FINGERED SPRING WASHER	1
5293441	1 3/16 I.D. X 1 1/2 O.D. X .018 THICK	2 WAVE SPRING WASHER (1 3/16)	5
5492771	1 3/8 I.D. X 1 13/16 O.D. X .025 THICK	2 WAVE SPRING WASHER (1 3/8)	1
2797591	1 13/32 I.D. X 1 7/8 O.D.	2 WAVE SPRING WASHER (1 13/32)	1

SPLIT LOCK WASHERS

Part No.	Size	Description	Package Quantity
9120030	6	SPLIT LOCK WASHER	10
9120200	8	SPLIT LOCK WASHER	10
9120320	10	SPLIT LOCK WASHER	10
9121300	10 mm	SPLIT LOCK WASHER	10
9120880	1/4	SPLIT LOCK WASHER	10
9121520	5/16	SPLIT LOCK WASHER	10
9122100	3/8	SPLIT LOCK WASHER	10
9122390	7/16	SPLIT LOCK WASHER	5
9122420	1/2	SPLIT LOCK WASHER	5

CLEVIS PINS

Part No.	Size	Description	Package Quantity
2391951	3/16 X 1	CLEVIS PIN	1
3393491	3/8 X 1 1/2	CLEVIS PIN	1
9121950	3/8 X 1 5/8	CLEVIS PIN WITH RETAINER - STEEL - ZINC PLATE	1
7690311	3/8 X 2.505	CLEVIS PIN	1
9122561	1/2 X 1 1/4	CLEVIS PIN	1
9122685	1/2 X 2 7/8	CLEVIS PIN - STEEL - ZINC PLATE	1



COTTER PINS

Part No.	Size	Description	Package Quantity
7690491	#6	HAIR COTTER PIN	1
2392561	#CC-7	CIRCLE COTTER PIN	1
4891441	1/8 X 3/8	HAIR SPRING COTTER PIN	1
9120310	1/8 X 3/4	COTTER PIN	10
9120312	1/8 X 1	HUMPED COTTER PIN	5
9120314	1/8 X 1 1/4	COTTER PIN	5
9121413	5/16 X 1	HAIR PIN COTTER PIN	5

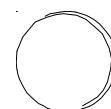

CIRCLE

COTTER

HUMPED COTTER

HAIR COTTER

ROLL PINS

Part No.	Size	Description	Package Quantity
9120830	3/32 X 5/8	ROLL PIN	10
9120315	1/8 X 1 1/4	ROLL PIN	5
9120828	1/8 X 1 3/4	ROLL PIN	4
9120820	3/16 X 1	ROLL PIN	5
7490111	1/4 X 1 1/4	ROLL PIN	1
9121043	1/4 X 1 1/8	ROLL PIN	5

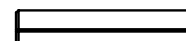

RIVETS - KEYS - TAMPER PROOF

RIVETS

Part No.	Size	Description	Package Quantity
7490121	3/32 X 1/4	RIVET - ALUMINUM	1
9120307	1/8 X 3/16	DOME HEAD POP RIVET - ALUMINUM	5
9120301	1/8 X 1/4	RIVET - BLIND - DOME HEAD - STEEL	10
9120309	1/8 X 1/2	DOME HEAD POP RIVET - STEEL	5
2391751	1/8 X 5/8	DOME HEAD POP RIVET - STEEL	1
9120319	5/32 X 3/8	DOME HEAD POP RIVET	5
6793541	5/32 X 1/2	POP RIVET	1
9120317	5/32 X 5/8	DOME HEAD POP RIVET - STEEL	5
9121955	3/16 X 1/2	DOME HEAD POP RIVET - ALUMINUM	5
9120817	3/16 X 11/16	DOME HEAD POP RIVET - ALUMINUM	5
9120313	9/32 X 1/32	FLAT HEAD RIVET - BRASS	5

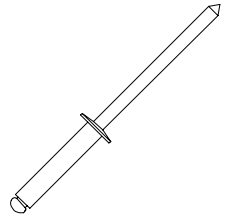

KEYS

Part No.	Size	Description	Package Quantity
9120303	1/8 SQUARE X 1/2 LONG	KEY - STEEL	2
9120815	3/16 SQUARE X 1/2 LONG	KEY - STEEL	1
9120818	3/16 SQUARE X 3/4 LONG	KEY - STEEL	1
9120825	3/16 SQUARE X 7/8 LONG	KEY - STEEL	1
9120827	3/16 SQUARE X 1 LONG	KEY	2
9120829	3/16 SQUARE X 1 1/2 LONG	KEY	4
9121310	1/4 SQUARE X 7/8 LONG	KEY - STEEL	2
2792681	1/4 SQUARE X 1 LONG	KEY - STEEL	1
9121315	1/4 SQUARE X 1 1/2 LONG	KEY - STEEL	2
9121317	1/4 SQUARE X 3 3/4 LONG	KEY - STEEL	2
9120013	1/8 SQUARE X 1/2 LONG	WOODRUFF KEY - STEEL	2
9120311	1/8 SQUARE X 1/2 LONG	WOODRUFF KEY - ALLOY	2

TAMPER PROOF HARDWARE

Part No.	Size	Description	Package Quantity
9120235	8-32 X 1/2	HEX HEAD SLOTTED SCREW	4
9120755	10-32 X 1/2	TRUSS HEAD PHILLIPS MACHINE SCREW	1
9121685	5/16-18 X 1	HEX BOLT	8
9121850	5/16-18 X 2 1/2	HEX BOLT	1
9121423	5/16-18	HEX NUT	2
9122003	3/8-16	HEX NUT	1
9120833	M5 X .08 X 20mm	PAN HEAD PHILLIPS MACHINE SCREW	2
9120228	8-32 X 1/4	BUTTON HEAD TORX CAP SCREW - WITH PIN	4
9120345	10-16 X 1/2	BUTTON TORX SHEET METAL SCREW - WITH PIN	6
9120617	10-24 X 3/4	BUTTON HEAD TORX CAP SCREW WITH PIN	5
9120711	10-32 X 1/2	BUTTON HEAD TORX CAP SCREW WITH PIN	3
9121581	5/16-18 X 3/4	BUTTON HEAD SOCKET CAP SCREW - WITH PIN	4
9122116	3/8-16 X 3/4	BUTTON HEAD SOCKET CAP SCREW - WITH PIN	4

MISCELLANEOUS - METRIC

MISCELLANEOUS HARDWARE

Part No.	Size	Description	Package Quantity
9120355	10-24	ACORN NUT - LOW CROWN WITH NY-LOK PATCH	1
9120007	1/8	ALLEN WRENCH - STEEL	2
9120560	10-24 X 1/4	BINDING HEAD SLOT MACHINE SCREW - BRASS	10
9120710	10-32 X 1/2	BUTTON HEAD SOCKET SCREW	10
9122030	3/8-16 X 3/4	BUTTON HEAD SOCKET SCREW	2
0394001	8-32 X 3/8	HEX HEAD SLOTTED SCREW	1
9120227	8-32 X 1/4	FILLISTER HEAD SLOT MACHINE SCREW	5
9122035	3/8-16 X 3/4	FLAT HEAD SOCKET CAP SCREW	2
9122323	3/8-16 X 1 1/4	FLAT HEAD SOCKET CAP SCREW	2
0394001	8-32 X 3/8	HEX HEAD SLOTTED SCREW	1
9120625	10-24 X 3/4	HEX WASHER HEAD SLOT THREAD CUTTING SCREW	2
9120760	10-32 X 1/2	HEX WASHER HEAD SLOT MACHINE SCREW	2
9120765	10-32 X 1/2	HEX WASHER HEAD SLOT MACHINE SCREW	1
9121135	1/4-20 X 1 3/4	THUMB SCREW	1
9120782	10 X 3/16	NYLON SCREW INSULATOR	1
9120783	10-38	NYLON SCREW INSULATOR	5
9121362	1/4-20 X 2 1/2	THREADED STUD	1
9121363	1/4-20 X 4 1/2	FULL THREADED STUD	2
6190921	3/8 -16 X 2 1/2	CARRIAGE BOLT	1
9121039	1/4-20 X 1 1/2	ELEVATOR BOLT - ZINC PLATED	1
9120845	1/4 X 1	HEX LAG BOLT	1
9123120	1/4-20 X 3/4 X 1 1/4	U-BOLT	1
9123130	1/4-20	U-BOLT	1
9123140	1/4 X 1 X 1 3/4	U-BOLT	1
9120025	6-32	DOUBLE HOLE - SWITCH SPEED NUT	1
9120923	1/4-20	HEX COUPLING NUT	1
9120925	1/4-20	1/2 DIAMETER X 5/8 LONG WELL NUT	1
6793081	1/4-20	1/2 DIAMETER X 1 LONG WELL NUT	1
6792971	.5 DIAMETER X .63 LONG	WELLNUT (1/4-20)	1
9123000	11" LONG	WIRE TIE	3
9123005	1/8 X 5 1/2	WIRE TIE	5
9123015	3/16 X 7 1/2	#10 MOUNTING HOLE WIRE TIE	5

METRIC

MUCH OF THE METRIC HARDWARE IS FOR OUR MACHINES LIKE THE DESIGNER'S, THE MANTA, THE PACERS AND THE SIDEWINDERS. THE HARDWARE IS SOLD BY THE PIECE AND NOT PRE - PACKAGED.

BOLTS / SCREWS

Part No.	Size	Description	Part No.	Size	Description
7293081	M3 X 13	PAN HEAD TORX THREAD CUTTING	7190531	M4 X 12	SCREW
6393591	M3.5 X 9.5	SCREW	7292711	M4 X 12	OVAL HEAD SCREW
7190521	M3.5 X 12	SCREW	6295731	M4 X 14	SET SCREW
6892221	M3.5 X 13	OVAL HEAD SCREW	5792581	M4 X 15	TRUSS PHILLIPS THREAD CUTTING
9120085	M3.5 X 19	PAN HEAD SHEET METAL SCREW	6295521	M4 X 16	ALLEN HEAD SCREW
5792551	M4 X 8	PAN HEAD PHILLIPS SCREW	6393601	M4 X 16	SCREW
6192831	M4 X 8	PAN HEAD SCREW	6891051	M4 X 16	THREAD CUTTING SCREW
6892201	M4 X 8	PAN HEAD SLOT SCREW	6891061	M4 X 16	PAN HEAD TORX THREAD CUTTING
7293091	M4 X 8	PAN HEAD TORX SCREW	7292701	M4 X 16	OVAL HEAD SCREW
6295281	M4 X 10	ALLEN HEAD SCREW	5792591	M4 X 22	PAN HEAD PHIL THREAD CUTTING
6295671	M4 X 10	ALLEN HEAD SCREW	6192771	M4 X 30	SCREW
6891021	M4 X 10	PAN HEAD TORX THREAD CUTTING	6891071	M4 X 30	PAN HEAD TORX THREAD CUTTING
6891011	M4 X 10	TORX HEAD SCREW	6194061	M4 X 35	SCREW
7293071	M4 X 10	PAN HEAD TORX MACHINE SCREW	5792491	M4.5 X 24	TRUSS HEAD THREAD CUTTING
6394561	M4 X 12	SCREW	5792561	M4.8 X 19	PAN HEAD PHILL THREAD CUTTING
6891031	M4 X 12	RD WASHER HD TORX THD CUTTING	6390751	M5 X 8	SET SCREW
6891041	M4 X 12	PAN HEAD TORX HEAD SCREW	6295581	M5 X 10	HEX HEAD SCREW

BOLTS / SCREWS - cont.

Part No.	Size	Description	Part No.	Size	Description
6295081	M5 X 12	ALLEN HEAD SCREW	6295691	M6 X 80	HEX HEAD SCREW
7694541	M5 X 12	CROSS SLOTTED SCREW	6390561	M6 X 110	SCREW
6192571	M5 X 14	SCREW - PAN HEAD	6390571	M6 X 140	SCREW
5797161	M5 X 15	TRUSS HD PHILL THD CUTTING	6390601	M6	HEXAGON SCREW
6891081	M5 X 16	PAN HEAD TORX - WITH PATCH	6394121	M8 X 10	SCREW
6891091	M5 X 16	ROUND HEAD TORX SCREW	6295381	M8 X 12	HEX HEAD SCREW
6394641	M5 X 16	SCREW	6890711	M8 X 13	SCREW
6295621	M5 X 16	ALLEN HEAD SCREW	6192981	M8 X 16	BOLT - FLANGED
6192801	M5 X 18	BOLT	6295191	M8 X 16	HEX HEAD SCREW
5791441	M5 X 20	TRUSS HEAD THREAD CUTTING	6295701	M8 X 16	ROUND HEAD SCREW
5798141	M5 X 20	TRUSS HEAD THREAD CUTTING	6295481	M8 X 16	HEX HEAD SCREW
6193291	M5 X 20	PAN HEAD SCREW	6393211	M8 X 16	SCREW
6393351	M5 X 20	SCREW	6393281	M8 X 16	SCREW
7190541	M5 X 20	SCREW	6193181	M8 X 18	BOLT - STUD
7694641	M5 X 20	CROSS SLOTTED SCREW	6295051	M8 X 20	HEX HEAD SCREW
9120833	M5 X 20	PAN HEAD PHILLIPS	7694671	M8 X 20	HEX HEAD SCREW
6295211	M5 X 25	ALLEN HEAD SCREW	6394211	M8 X 22	SCREW
5792571	M5 X 25	PAN HEAD PHILLIPS	6395421	M8 X 22	SCREW
5792611	M5 X 25	ROUND HEAD THREAD CUTTING	6295181	M8 X 25	SCREW
5791451	M5 X 30	TRUSS HEAD THREAD CUTTING	6393821	M8 X 25	SCREW
7292211	M5 X 30	PAN HEAD TORX WITH PATCH	6193541	M8 X 30	BOLT - FLANGED
5792631	M5 X 35	TRUSS HEAD THREAD CUTTING	6295171	M8 X 35	SCREW
5792111	M5 X 40	PAN HEAD PHILLIPS - BRASS	6295161	M8 X 40	HEX HEAD SCREW
7190551	M5 X 40	SCREW	6390611	M8 X 40	HEXAGON SCREW
5792461	M5.2 X 50	TRUSS HEAD THREAD CUTTING	6193161	M8 X 50	BOLT - FLANGED
6393981	M5 X 70	SCREW	6295511	M8 X 50	HEX HEAD SCREW
6295441	M6 X 1	HEX HEAD SCREW	6193171	M8 X 75	BOLT - FLANGED
6295221	M6 X 8	ALLEN HEAD SCREW	9121290	M10 X 1.5	FULL THREADED HEX BOLT - STEEL
6394411	M6 X 10	SCREW	6393551	M10 X 16	SCREW
6394451	M6 X 10	SCREW	6295751	M10 X 20	COUNTER SUNK SCREW
7694551	M6 X 10	CAMBER HEAD SCREW	6295681	M10 X 20	COUNTERSUNK SCREW
6192581	M6 X 12	BOLT - FLANGED	6390581	M10 X 75	SCREW
6295031	M6 X 12	HEX HEAD SCREW	6390551	M10 X 110	SCREW
7694741	M6 X 12	CROSS SLOTTED SCREW	7694751	M10 X 120	HEX HEAD SCREW
7695111	M6 X 12	CROSS SLOTTED SCREW	6193271	M12 X 30	BOLT
9120835	M6 X 12.7	HEX BOLT	6390621	M16 X 50	PT SCREW
6192951	M6 X 16	BOLT - FLANGED	6390641	M16 X 60	PT SCREW
6295501	M6 X 16	COUNTER SUNK SCREW	6390651	M20 X 60	PT SCREW
6295071	M6 X 16	HEX HEAD SCREW	6390671	M25 X 50	PT SCREW
6393721	M6 X 16	SCREW	6390661	M25 X 60	PT SCREW
6394691	M6 X 16	SCREW	6390681	M30 X 50	PT SCREW
7694581	M6 X 16	HEX HEAD SCREW	6390631	M35 X 60	PT SCREW
7694701	M6 X 16	CAMBER HEAD SCREW	6393951	M12 X 40	SCREW
6295611	M6 X 18	ALLEN HEAD SCREW	5792831	M12 X 150	HEX HEAD BOLT
6393221	M6.3 X 19	SCREW	6193741		BOLT
6192961	M6 X 20	BOLT - FLANGED	6194121		BOLT
6393971	M6 X 20	SCREW	6194131		BOLT
6394701	M6 X 20	SCREW	6194141		BOLT
6295491	M6 X 20	COUNTER SUNK SCREW	6295201		FLAT END SET SCREW
6295411	M6 X 20	HEX HEAD SCREW	6193241		SCREW
6192971	M6 X 25	BOLT - FLANGED	6193691		SCREW
6393411	M6 X 25	SCREW	6297161		SCREW - FLAP CONTROLLER
5791231	M6 X 30	HEX HEAD BOLT	6394711		SCREW - HOOD
6192811	M6 X 30	BOLT	6393791		SCREW - WIRE FIXING
6192641	M6 X 35	BOLT - FLANGED	6393851		SCREW - TIGHTENER ROLLER
6194101	M6 X 35	BOLT	7190571		SCREW - UNION PART
6194111	M6 X 35	BOLT	6292671		SUPPORT SCREW
6390591	M6 X 35	HEXAGON SCREW	6295401		TAPERED END SET SCREW
6193151	M6 X 40	BOLT - FLANGED	6295631		THREAD CUTTING
6390541	M6 X 40	SCREW	6190611		WHEELAXLE BOLT
7695091	M6 X 40	ROUND HEAD SCREW	7692131		WHEEL BOLTS - DRIVE WHEEL
6295651	M6 X 70	HEX HEAD SCREW			

DOWELS - KEYS - PINS - RIVETS - NUTS

DOWELS

Part No.	Size	Description
6393781	M5 X 6	DOWEL
6394031	M6 X 5	DOWEL
6394551	M6 X 10	DOWEL

KEYS

Part No.	Size	Description
6291071	M4 X 4 X 18	KEY
6295421	M5 X 5 X 15	KEY
6394011	M5 X 5 X 15	KEY
6291041	M5 X 5 X 20	KEY
7694531	M5 X 20	KEY
6394511	M5 X 5 X 25	KEY
6295241	M6 X 6 X 12	KEY
6394651		KEY
6291371		KEY - BRUSH ROLLER
6290891		KEY - WHEEL HUB
6291441		KEY - FOR SUPPORT
6193301		WOODRUFF KEY

PINS

Part No.	Size	Description
6890201	3MM X 12.3MM	ROLL PIN
6390781	M6 X 30	PIN
6394191	M17 X 34	PIN
6394611		PIN - BELT SUPPORT
6393911		PIN - FOR ROCKER
6890321		PIN - SWITCHACTIVATOR
6291701		PIN
6297231		PIN - BRUSH ADJUSTER
6290191		PIN - SPRING
6290451		SPLIT PIN
6295231		SPLIT PIN

RIVETS

Part No.	Size	Description
5791271	4MM	RIVET - PLASTIC
6295591	M4.8 DIA. X 12	RIVET
5791621	5MM X 9	DOME HEAD POP RIVET
5791361	5MM X 9MM	DOME HEAD POP RIVET

NUTS

Part No.	Size	Description
6393611	M4	NUT
6295261	M4	NUT
5792641	M5	ACORN NUT - HIGH CROWN
7190561	M5	HEX NUT
9122005	M5	HEX NUT - BRASS
6295091	M5	NUT
6393671	M5	NUT
7694661	M5	SELF LOCKING NUT
6891101	M5	SQUARE NUT
6393941	M6	LOCK NUT
6295011	M6	NUT
6390721	M6	NUT
6192841	M6	HEX NUT
5791301	M6	HEX NUT - BRASS
6393291	M6	NUT - FOOT
6296581	M6	SELF LOCKING NUT
7694571	M6	SELF LOCKING NUT
6295301	M6	WING NUT
6390691	M6	WING NUT
5793091	M8	HEX NUT
6192631	M8	HEX NUT
5791341	M8	HIGH CROWN ACORN NUT
6393811	M8	LOCK NUT
6295131	M8	NUT
6393151	M8	NUT
6394141	M8	NUT - SIDE BRUSH
6295351	M8	SELF LOCKING NUT
6390701	M8	STOP NUT
6295021	M10	NUT
7694621	M10	SELF LOCKING NUT
6390711	M10	STOP NUT
6296771	M10.5	NUT
6394321	M12	LOCK NUT
5792871	M12	HIGH CROWN ACORN NUT
6393751	M12	KNURLED RING NUT
6295311	M12	NUT
6295711	M12	NUT
7694761	M14 X 1.5	SELF LOCKING NUT
6393491	M18	NUT
6192541		NUT
6192591		NUT
6193701		NUT
6297031		LOCKING RING NUT
5792651		KEPS NUT
6390231		NUT SUPPORT

WASHERS

Part No.	Size	Description
0393851	M3	FLAT WASHER
7292261	M3.5 I.D. X 6.8 O.D. X 4MM THICK	FLAT WASHER (PLASTIC)
6295271	M4	SPRING WASHER
7291111	M4	WASHER - FOOT PEDAL
7293111	M4	WASHER - FOOT PEDAL
6295291	M4 I.D. X 9 O.D. X 1	WASHER
7292271	M4.4	EXTERNAL STAR LOCK WASHER
6891121	M4.4 I.D. X 8.8 O.D. X .8 THICK	FLAT WASHER
6891111	M4.5 I.D. X 11.8 O.D. X 1 THICK	FLAT WASHER
6295451	M5	WASHER
5793201	M5	WASHER - PLASTIC
6393391	M5 X 10	WASHER
6394571	M5 X 20	WASHER
6295111	M6	SPRING WASHER
6295041	M6	WASHER
7694611	M6	SPLIT LOCK WASHER
6192851	M6	WASHER - PLAIN
6295101	M6 I.D. X 18 O.D. X 1.5 THICK	WASHER
6393731	M6 X 12	WASHER
6394681	M6 X 18	WASHER
6393191	M6 X 24 X 2	WASHER
7694651	M6.4 I.D. X 12.5 O.D. X 1.6	THICK WASHER
7292281	M6.4 I.D. X 11.7 O.D. X 16. THICK	FLAT WASHER
7694561	M6.5 I.D. X 18 O.D. X 2	THICK WASHER
7694601	M8	SPLIT LOCK WASHER
6295151	M8	SPRING WASHER
6192621	M8	WASHER - SPRING
6295061	M8	WASHER
6295141	M8	WASHER
6593621	M8	WASHER
6393801	M8 X 1	WASHER
6394231	M8 X 2	WASHER
7694591	M8 I.D. X 17 O.D. X 1	WASHER
6394361	M8 X 24	WASHER
5793031	M8.4 I.D. X 17.0 O.D. X 1.5 THICK	FLAT WASHER
5791331	M8	FLAT WASHER
6295321	M10	SPRING WASHER
6295371	M10	WASHER
6390731	M10.5	WASHER
5793081	M10.7 I.D. X 21.1 O.D. X 20 THICK	FLAT WASHER
5793061	M11.6 I.D. X 30 O.D. X 2.5 THICK	FLAT WASHER
6295251	M12 I.D. X 24 O.D. X 2.5 THICK	WASHER
5792841	M12.9 I.D. X 23.9 O.D. X 2.5 THICK	FLAT WASHER
7694721	M15 I.D. X 21 O.D. X 1 THICK	WASHER
5793071	M20.7 I.D. X 37 O.D. X 3 THICK	FLAT WASHER
7694981	M22 I.D. X 40 O.D. X 1.5	WASHER
6193281		WASHER
6193751		WASHER
6593291		WASHER - VALVE SPRING
7190381		LOCK WASHER
6290571		WASHER
6290591		WASHER
6290711		WASHER
6290931		WASHER
6291871		WASHER
6295121		WASHER
6296561		WASHER



NSS ® Enterprises, Inc.

3115 Frenchmens Road, Toledo, Ohio 43607

PHONE (419) 531-3761 FAX (419) 531-3761

NSS ® Enterprises, Inc. European Distribution Centre

Unit II, Pinfold Trading Estate * 55 Nottingham Road
STAPLEFORD, NOTTINGHAM NG9 8AD ENGLAND U.K.

PHONE: (44) 0115 939 1568 * FAX: (44) 0115 949 0615

WEB SITE WWW.NSS.COM

E-MAIL MAILUS@NSS.COM